



# DIN RAIL VOLTAGE OUTPUT DIFFERENTIAL PRESSURE TRANSDUCER LOW DIFFERENTIAL PRESSURES

**PX663 Series**  
1 to 5 Vdc Output  
0-0.1 to 0-50 inH<sub>2</sub>O  
0-0.25 to 0-125 mbar

Starts at  
**\$600**



- ✓ Compact Space-Saving DIN Rail Mountable Design
- ✓ Low Differential Pressure Ranges
- ✓ On-Board Voltage Regulation Allows Use of Low-Cost, Unregulated Power Supply

## SPECIFICATIONS

**Excitation:** 12 to 36 Vdc

**Output:** 1 to 5 Vdc

**Accuracy:** ±0.5% FS

**Non-Linearity:** ±0.4% FS

**Hysteresis:** ±0.02% FS

**Non-Repeatability:** ±0.05%

**Supply Current:** <10 mA

**Warm-Up Time:** 5 sec max to meet standard specifications from initial power-up

**Stability:** Max change (FS/year) ±0.5%

**Response Time:** 250 ms

**Temperature Limits:**

**Storage:** -40 to 82°C (-40 to 180°F)

**Operating:** -28 to 82°C (-20 to 180°F)  
(10 to 95% RH non-condensing)

**Compensated:** 2 to 57°C (35 to 135°F)

### Thermal Coefficients:

**Zero:** ±0.036% FS/°C (±0.02% FS/°F)

**Span:** ±0.036% FS/°C (±0.02% FS/°F)

**EMC:** CE compliant to EN61326:  
1997 ANNEX A harmonized heavy  
industrial transmitter specification

### Overpressure Limits:

**Proof:** 15 psid

**Burst:** 25 psi

**Max Static Pressure:** 25 psi

### Mounting Position Effect:

0.5" WC and higher 0.1% FS/g  
Below 0.5" WC 0.25% FS/g

**Note:** Mounting position effect easily  
corrected with zero potentiometer

### Zero and Span Potentiometers (Front Accessible, Non-Interactive):

**Zero:** ±5% FS

**Span:** ±3% FS

**Pressure Connections:** 1/8 NPT female

**Weight:** 127 grams (4.5 oz)

**Enclosure:** Glass-filled polycarbonate  
(UL94 -V-1)

### Pressure Media:

Clean, dry and non-corrosive gas  
NOT FOR USE WITH LIQUIDS

### Mounting:

DIN rail types EN50022, 35 and 45



PX663-5BD5V, \$600, shown larger than actual size, includes calibration kit and test jacks, not shown.



# DIN RAIL VOLTAGE OUTPUT DIFFERENTIAL PRESSURE TRANSDUCERS



Calibration Kit Included!

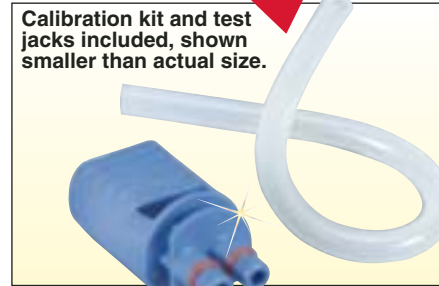
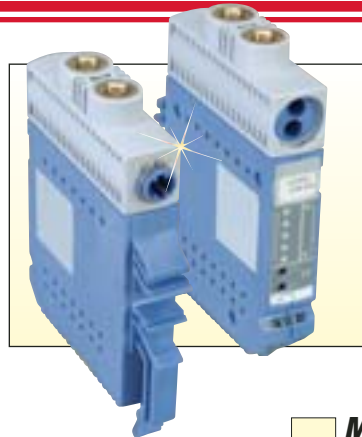
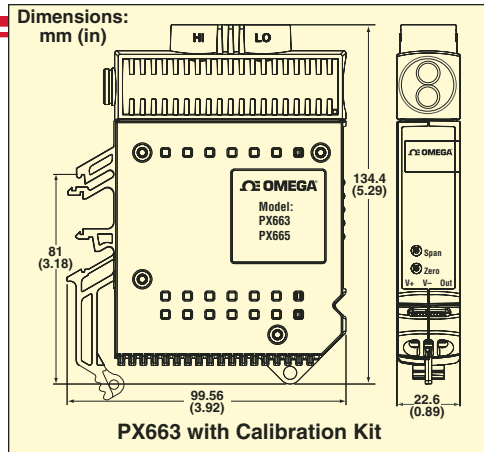

  **MOST POPULAR MODELS HIGHLIGHTED!**

## To Order (Specify Model Number)

RANGE		MODEL NO.	PRICE	COMPATIBLE METERS*
inH <sub>2</sub> O	mbar			
0 to 0.10	0.25	PX663-0.1D5V	\$705	DP25B-E, DPi8, DP41-E
0 to 0.25	0.62	PX663-0.25D5V	630	DP25B-E, DPi8, DP41-E
0 to 0.50	1.25	PX663-0.5D5V	600	DP25B-E, DPi8, DP41-E
0 to 0.75	1.87	PX663-0.75D5V	600	DP25B-E, DPi8, DP41-E
0 to 1.00	2.50	PX663-1D5V	600	DP25B-E, DPi8, DP41-E
0 to 1.50	3.70	PX663-1.5D5V	600	DP25B-E, DPi8, DP41-E
0 to 2.00	5.00	PX663-2D5V	600	DP25B-E, DPi8, DP41-E
0 to 2.50	6.20	PX663-2.5D5V	600	DP25B-E, DPi8, DP41-E
0 to 3.00	7.50	PX663-3D5V	600	DP25B-E, DPi8, DP41-E
0 to 5.00	12.50	PX663-5D5V	600	DP25B-E, DPi8, DP41-E
0 to 10.00	24.90	PX663-10D5V	600	DP25B-E, DPi8, DP41-E
0 to 15.00	37.40	PX663-15D5V	600	DP25B-E, DPi8, DP41-E
0 to 20.00	49.80	PX663-20D5V	600	DP25B-E, DPi8, DP41-E
0 to 25.00	62.30	PX663-25D5V	600	DP25B-E, DPi8, DP41-E
0 to 50.00	125.00	PX663-50D5V	600	DP25B-E, DPi8, DP41-E
<b>BI-DIRECTIONAL RANGES</b>				
±0.05	±0.12	PX663-0.05BD5V	\$705	DP25B-E, DPi8, DP41-E
±0.10	±0.25	PX663-0.1BD5V	660	DP25B-E, DPi8, DP41-E
±0.25	±0.62	PX663-0.25BD5V	630	DP25B-E, DPi8, DP41-E
±0.50	±1.25	PX663-0.5BD5V	600	DP25B-E, DPi8, DP41-E
±0.75	±1.87	PX663-0.75BD5V	600	DP25B-E, DPi8, DP41-E
±1.00	±2.50	PX663-1BD5V	600	DP25B-E, DPi8, DP41-E
±2.00	±5.00	PX663-2BD5V	600	DP25B-E, DPi8, DP41-E
±2.50	±6.20	PX663-2.5BD5V	600	DP25B-E, DPi8, DP41-E
±3.00	±7.50	PX663-3BD5V	600	DP25B-E, DPi8, DP41-E
±5.00	±12.50	PX663-5BD5V	600	DP25B-E, DPi8, DP41-E
±10.00	±24.90	PX663-10BD5V	600	DP25B-E, DPi8, DP41-E
±25.00	±125.00	PX663-25BD5V	600	DP25B-E, DPi8, DP41-E

## ACCESSORY

MODEL NO.	PRICE	DESCRIPTION
OP-6	\$340	Reference Book: Fundamentals of Temperature, Pressure, and Air Flow Measurement

\* See section D for compatible meters.

Comes with complete operator's manual, calibration kit and test jacks. Custom configurations available. Please consult Engineering.

Ordering Example: PX663-2.5BD5V, low-pressure differential pressure transducer, ±2.5 inH<sub>2</sub>O, \$600.

DIFFERENTIAL PRESSURE TRANSDUCERS B



# DIN RAIL CURRENT OUTPUT DIFFERENTIAL PRESSURE TRANSMITTER LOW DIFFERENTIAL PRESSURES

**PX665 Series**  
4 to 20 mA Output  
0-0.1 to 0-50 inH<sub>2</sub>O  
0-0.25 to 0-125 mbar

Starts at  
**\$590**



PX665-5BDI, \$590, shown larger than actual size, includes calibration kit and test jacks, not shown.



- ✓ Compact Space-Saving DIN Rail Mount Design
- ✓ Low Differential Pressure Ranges
- ✓ On-Board Voltage Regulation Allows Use of Low-Cost, Unregulated Power Supply

## SPECIFICATIONS

**Excitation:** 12 to 36 Vdc

**Output:** 4 to 20 mA

**Accuracy:**  $\pm 0.5\%$  FS

**Non-Linearity:**  $\pm 0.4\%$  FS

**Hysteresis:**  $\pm 0.02\%$  FS

**Non-Repeatability:**  $\pm 0.05\%$

**Warm-Up Time:** 5 sec max to meet standard specifications from initial power-up

**Stability:** Max change (FS/year)  $\pm 0.5\%$

**Response Time:** 250 ms

**Temperature Limits:**

**Storage:** -40 to 82°C (-40 to 180°F)

**Operating:** -28 to 82°C (-20 to 180°F)  
(10 to 95% RH non-condensing)

**Compensated:** 2 to 57°C (35 to 135°F)

**Thermal Coefficients:**

**Zero:**  $\pm 0.036\%$  FS/°C ( $\pm 0.02\%$  FS/°F)

**Span:**  $\pm 0.036\%$  FS/°C ( $\pm 0.02\%$  FS/°F)

**EMC:** CE compliant to EN61326:  
1997 ANNEX A harmonized heavy industrial transmitter specification

**Overpressure Limits:**

**Proof:** 15 psid

**Burst:** 25 psi

**Max Static Pressure:** 25 psi

**Mounting Position Effect:**

0.5" WC and higher 0.1% FS/g  
Below 0.5" WC 0.25% FS/g

**Note:** Mounting position effect easily corrected with zero potentiometer

**Zero and Span Potentiometers (Front Accessible, Non-Interactive):**

**Zero:**  $\pm 5\%$  FS

**Span:**  $\pm 3\%$  FS

**Pressure Connections:** 1/8 NPT female

**Weight:** 127 g (4.5 oz)

**Enclosure:** Glass-filled polycarbonate (UL94 -V-1)

**Pressure Media:**

Clean, dry and non-corrosive gas  
NOT FOR USE WITH LIQUIDS

**Mounting:**

DIN rail types EN50022, 35 and 45

# DIN RAIL CURRENT OUTPUT DIFFERENTIAL PRESSURE TRANSMITTER

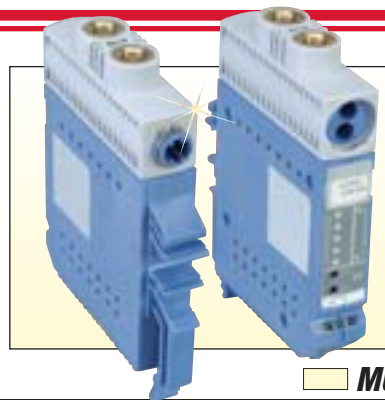
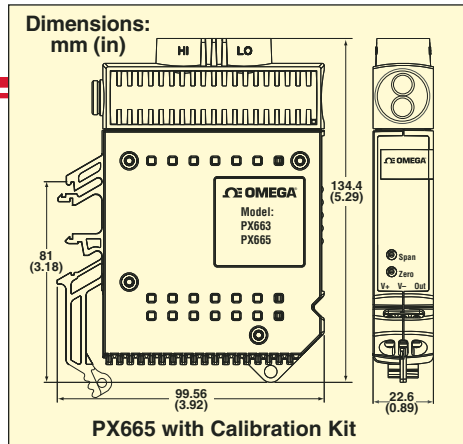

Calibration Kit Included!

Calibration kit and test jacks included, shown smaller than actual size.

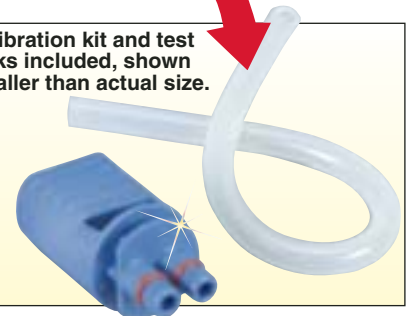

**MOST POPULAR MODELS HIGHLIGHTED!**

## To Order (Specify Model Number)

RANGE		MODEL NO.	PRICE	COMPATIBLE METERS*
inH <sub>2</sub> O	mbar			
0 to 0.10	0.25	PX665-0.1DI	\$695	DP25B-E, DPi8, DP41-E
0 to 0.25	0.62	PX665-0.25DI	650	DP25B-E, DPi8, DP41-E
0 to 0.50	1.25	PX665-0.5DI	620	DP25B-E, DPi8, DP41-E
0 to 0.75	1.87	PX665-0.75DI	590	DP25B-E, DPi8, DP41-E
0 to 1.00	2.50	PX665-1DI	590	DP25B-E, DPi8, DP41-E
0 to 1.50	3.70	PX665-1.5DI	590	DP25B-E, DPi8, DP41-E
0 to 2.00	5.00	PX665-2DI	590	DP25B-E, DPi8, DP41-E
0 to 2.50	6.20	PX665-2.5DI	590	DP25B-E, DPi8, DP41-E
0 to 3.00	7.50	PX665-3DI	590	DP25B-E, DPi8, DP41-E
0 to 5.00	12.50	PX665-5DI	590	DP25B-E, DPi8, DP41-E
0 to 10.00	24.90	PX665-10DI	590	DP25B-E, DPi8, DP41-E
0 to 15.00	37.40	PX665-15DI	590	DP25B-E, DPi8, DP41-E
0 to 20.00	49.80	PX665-20DI	590	DP25B-E, DPi8, DP41-E
0 to 25.00	62.30	PX665-25DI	590	DP25B-E, DPi8, DP41-E
0 to 50.00	125.00	PX665-50DI	590	DP25B-E, DPi8, DP41-E
<b>BI-DIRECTIONAL RANGES</b>				
±0.05	±0.12	PX665-0.05BDI	\$695	DP25B-E, DPi8, DP41-E
±0.10	±0.25	PX665-0.1BDI	650	DP25B-E, DPi8, DP41-E
±0.25	±0.62	PX665-0.25BDI	620	DP25B-E, DPi8, DP41-E
±0.50	±1.25	PX665-0.5BDI	590	DP25B-E, DPi8, DP41-E
±0.75	±1.87	PX665-0.75BDI	590	DP25B-E, DPi8, DP41-E
±1.00	±2.50	PX665-1BDI	590	DP25B-E, DPi8, DP41-E
±2.00	±5.00	PX665-2BDI	590	DP25B-E, DPi8, DP41-E
±2.50	±6.20	PX665-2.5BDI	590	DP25B-E, DPi8, DP41-E
±3.00	±7.50	PX665-3BDI	590	DP25B-E, DPi8, DP41-E
±5.00	±12.50	PX665-5BDI	590	DP25B-E, DPi8, DP41-E
±10.00	±24.90	PX665-10BDI	590	DP25B-E, DPi8, DP41-E
±25.00	±125.00	PX665-25BDI	590	DP25B-E, DPi8, DP41-E

## ACCESSORY

MODEL NO.	PRICE	DESCRIPTION
OP-6	\$340	Reference Book: Fundamentals of Temperature, Pressure, and Air Flow Measurement

\* See section D for compatible meters.

Comes with complete operator's manual calibration kit and test jacks.

Custom configurations available. Please consult Engineering.

Ordering Example: PX665-2.5BDI, low-pressure differential pressure transducer, ±2.5 inH<sub>2</sub>O range, \$590.

# omega.co.uk<sup>®</sup>

Your One-Stop Source for Process Measurement and Control!

Freephone 0800 488 488 | International +44(0) 161 777 6622 | Fax +44(0) 161 777 6622 | Sales@omega.co.uk

[www.omega.co.uk](http://www.omega.co.uk)



#### UNITED STATES

[www.omega.com](http://www.omega.com)

1-800-TC-OMEGA  
Stamford, CT.

#### CANADA

[www.omega.ca](http://www.omega.ca)

Laval(Quebec)  
1-800-TC-OMEGA

#### GERMANY

[www.omega.de](http://www.omega.de)

Deckenfronn, Germany  
0800-8266342

#### UNITED KINGDOM

[www.omega.co.uk](http://www.omega.co.uk)

Manchester, England  
0800-488-488  
+44-(0)161-777-6611

#### FRANCE

[www.omega.fr](http://www.omega.fr)

0800-466-342

#### BENELUX

[www.omega.nl](http://www.omega.nl)

0800-099-33-44



## More than 100,000 Products Available!

### • Temperature

Calibrators, Connectors, General Test and Measurement Instruments, Handheld Instruments for Temperature Measurement, Ice Point References, Indicating Labels, Crayons, Cements and Lacquers, Infrared Temperature Measurement Instruments, Recorders, Relative Humidity Measurement Instruments, PT100 Probes, PT100 Elements, Temperature & Process Meters, Timers and Counters, Temperature and Process Controllers and Power Switching Devices, Thermistor Elements, Probes and Assemblies, Thermocouples, Thermowells and Head and Well Assemblies, Transmitters, Thermocouple Wire, RTD Probes

### • Flow and Level

Air Velocity Indicators, Doppler Flowmeters, Level Measurement, Magnetic Flowmeters, Mass Flowmeters, Pitot Tubes, Pumps, Rotameters, Turbine and Paddle Wheel Flowmeters, Ultrasonic Flowmeters, Valves, Variable Area Flowmeters, Vortex Shedding Flowmeters

### • pH and Conductivity

Conductivity Instrumentation, Dissolved Oxygen Instrumentation, Environmental Instrumentation, pH Electrodes and Instruments, Water and Soil Analysis Instrumentation

### • Data Acquisition

Communication Products and Converters, Data Acquisition and Analysis Software, Data Loggers Plug-in Cards, Signal Conditioners, USB, RS232, RS485, Ethernet and Parallel Port Data Acquisition Systems, Wireless Transmitters and Receivers

### • Pressure, Strain and Force

Displacement Transducers, Dynamic Measurement Force Sensors, Instrumentation for Pressure and Strain Measurements, Load Cells, Pressure Gauges, Pressure Reference Section, Pressure Switches, Pressure Transducers, Proximity Transducers, Regulators, Pressure Transmitters, Strain Gauges, Torque Transducers, Valves

### • Heaters

Band Heaters, Cartridge Heaters, Circulation Heaters, Comfort Heaters, Controllers, Meters and Switching Devices, Flexible Heaters, General Test and Measurement Instruments, Heater Hook-up Wire, Heating Cable Systems, Immersion Heaters, Process Air and Duct, Heaters, Radiant Heaters, Strip Heaters, Tubular Heaters